

Alexa & Google Home Connectivity

“Alexa, set pool heater to 28 degrees.”

“Hey Google, what is the water temperature?”



How to Control Your Supreme Heating Pool Heat Pump with **Amazon Alexa**

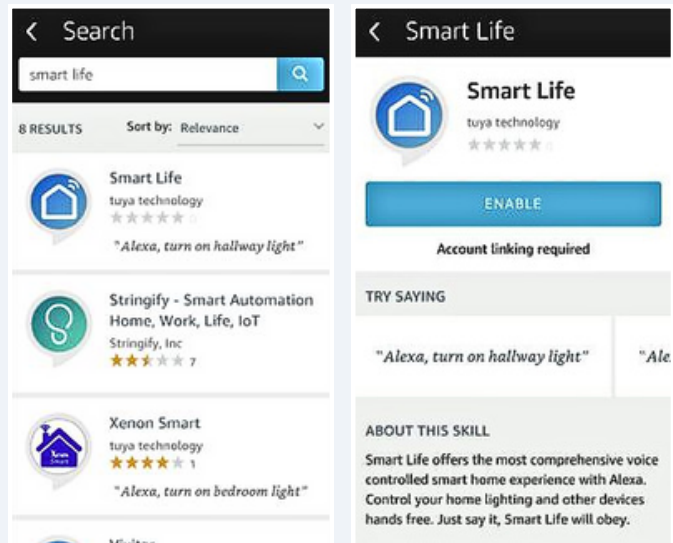

Step 1 Set up the Smart Life App

1. Download the Smart Life app.
2. Register an account—select **Australia** when choosing your region.
3. Add your pool heat pump:
4. Open the app and tap "+".
5. Make sure the heat pump is in pairing mode (check your product manual for how to do this).
6. Follow the prompts in EZ mode (fast flashing Wi-Fi light) or AP mode (slow flashing).
7. Rename your device in plain English for easier voice control (e.g., "Pool Heater").

Step 2 Link Smart Life to Alexa

- In the Alexa app, go to **More → Skills & Games**.
- Search for **Smart Life**.
- Select it, then tap **Enable to Use**.
- Sign in with your Smart Life account details.

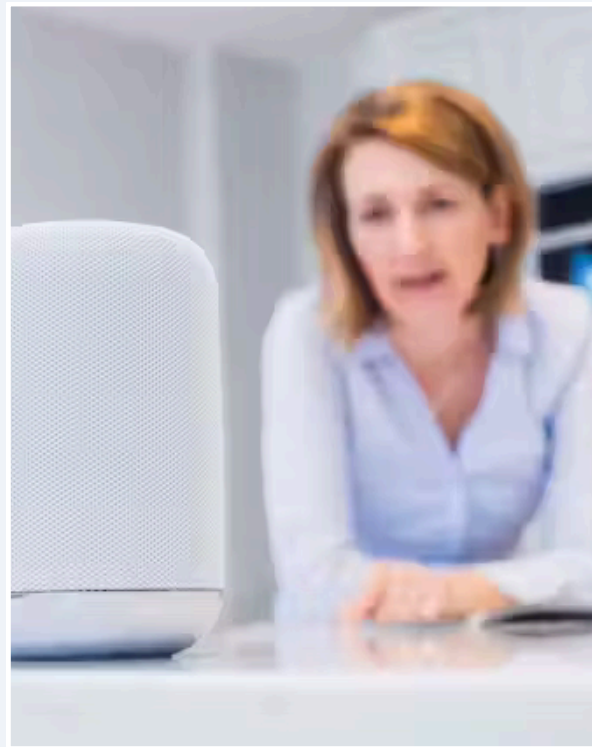
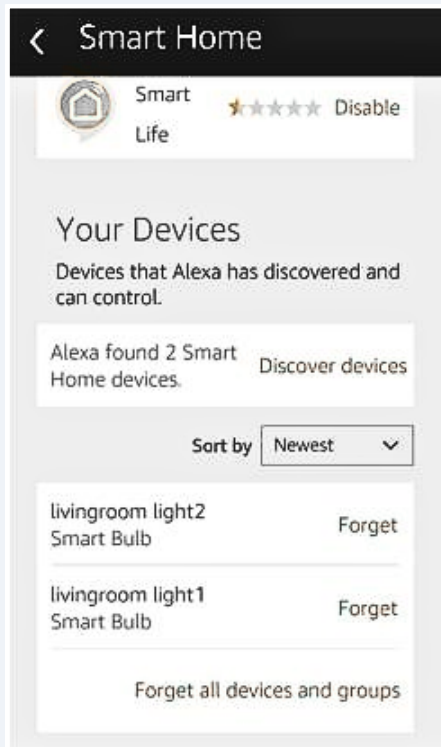

Step 3

Link Your Device to Alexa

1. Once linked, ask Alexa to discover devices or tap **"Discover Devices"** in the app. Alternatively you can use voice command by saying ***"Echo(or Alexa), Discover my devices."***
2. Echo will start to finding the devices which is added in Smart life APP, it will take about 20 seconds.

Step 4

Control your Pool Heat Pump by voice

Now you're ready to control your Supreme Heating pool heat pump hands-free. Try commands like:

"Alexa, set pool heater to 28 degrees."

"Alexa, increase pool heater by 2 degrees."

"Alexa what is the water temperature?"

How to Control Your Supreme Heating Pool Heat Pump with Google Home

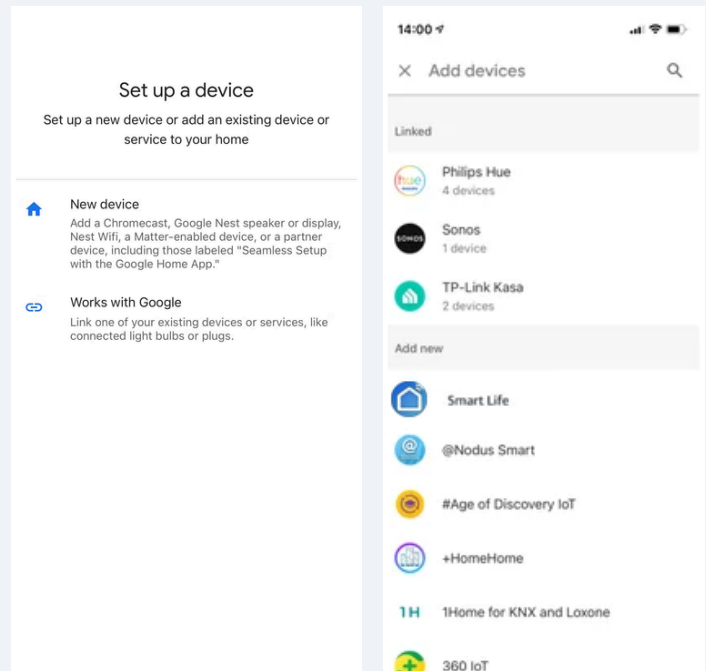

Step 1 Set up the Smart Life App

1. Download the Smart Life app.
2. Register an account—select **Australia** when choosing your region.
3. Add your pool heat pump:
4. Open the app and tap “+”.
5. Make sure the heat pump is in pairing mode (check your product manual for how to do this).
6. Follow the prompts in EZ mode (fast flashing Wi-Fi light) or AP mode (slow flashing).
7. Rename your device in plain English for easier voice control (e.g., “Pool Heater”).

Step 2 Link Smart Life to Google Home

1. Open the Google Home app.
2. Tap the “+” icon in the top-left corner.
3. Select **Set up device** → **Works with Google**.
4. Search for Smart Life in the list of available services.
5. Select **Smart Life**, then sign in with your Smart Life account details.
6. Allow Google to access and control your devices.

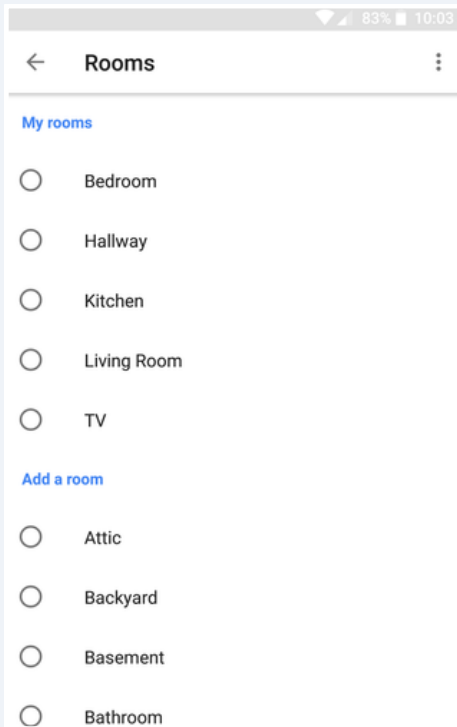

Step 3

Assign Your Pool Heater to a Room

1. In the Google Home app, find your Pool Heater in the device list.
2. Assign it to a room (e.g., "Backyard" or "Pool Area") for easier group commands.

Step 4

Control your Pool Heat Pump by voice

Once linked, you can control your pool heater with Google Assistant. Try saying:

"Hey Google, set pool heater to 28 degrees."

"Hey Google, increase pool heater by 2 degrees."

"Hey Google, decrease pool heater by 3 degrees."